



Designer Door Adjustment

Hinge Adjustments

COMPACT 38C / 39C series
107° / 110° hinges

Side Adjustment



Turn front screw counter-clockwise to increase door overlay, clockwise to decrease.
Range = $\frac{1}{8}$ "

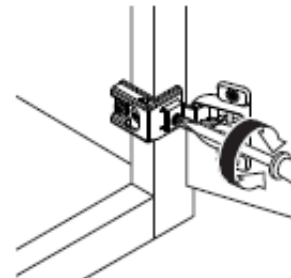

Height Adjustment

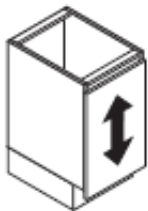

Loosen center screw. Adjust door to position and tighten screw.
Range = $\frac{1}{4}$ "

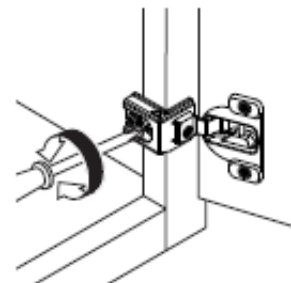

Depth Adjustment

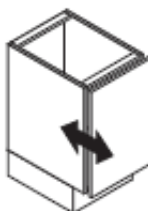

Turn back screw counter-clockwise to increase door gap, clockwise to decrease.
Range = $-\frac{1}{32}$ " + $\frac{3}{32}$ "

